

A	B	C	D	E	F	G	H	J	K
---	---	---	---	---	---	---	---	---	---

INSTRUKSJONER TIL BRUKERE AV MIDLERTIDIGE ELEKTRISKE ANLEGG

1. En kompetent person skal ha tilsyn med anlegget og være ansvarlig for driften. Feil bruk av det elektriske anlegget kan medføre fare for personskade og brann.
2. Sentralen skal plasseres loddrett eller på stativ, og med fritt betjeningsområde foran sentralen.
3. Faste tilkoblinger av kabler og bytte av sikringer skal bare utføres av fagfolk. Ved fast tilkobling av gummikabler skal strekkavlastningens klemflate være utført i isolasjonsmateriale. Ikke-fagfolk skal kun betjene jordfeilbryter, automatsikring og uttak for stikkontakter.
4. Sentralens dører skal være lukket og om nødvendig også låst. Dørene skal bare åpnes ved betjening av sentralen.
5. Elektriske apparater som er koblet til sentralen, skal kobles fra eller gjøres spenningsløse når de ikke er i bruk, for å unngå utilsiktet igangsetting eller anvendelse av disse.
6. De elektriske apparatene som brukes, må oppfylle forskriftene og skal enten være utstyrt med ekstra isolasjon eller, i klasse 1-utførelse, med jordet stikkontakt.
7. Kabler må legges slik at de ikke blir skadet. Det gjelder kabler både innenfor og utenfor dørene.
8. Kabler eller apparater med feil skal frakobles og ikke tas i bruk igjen før de defekte delene er skiftet eller reparert.
9. Knivsikring må bare byttes av kompetent personale.

INSTRUCTIONS FOR USERS OF TEMPORARY ELECTRICAL INSTALLATIONS

1. Operation of the installation must be supervised by an authorised person. Incorrect use of the electrical installation could mean risk of personal injury and fire.
2. The distribution unit must be installed vertical or on a stand so that there is free access in front of the unit.
3. Permanent cable connection or replacement of fuses may only be carried out by qualified personnel. Permanently connected rubber-insulated cables must be secured with a restraint that has an insulating gripping surface. Unqualified personnel may only operate earth leakage circuit breakers, miniature circuit breakers and plug sockets.
4. Distribution unit doors must be closed and, where required, also locked. Doors must only be left open when carrying out work on the distribution unit.
5. Electrical equipment that is connected to distribution units must be disconnected or switched off when not in use in order to avoid unintentional starting up or switching on.
6. Electrical equipment that is used must comply with the requirements and must either have additional insulation or comply with class I and have an earthed plug.
7. Cables inside and outside the doors must be routed so as to avoid damaging them.
8. Cables or equipment that are defective must be disconnected and not used until the defective parts have been replaced or repaired.
9. Blade fuses may only be replaced by personnel who have the necessary training.

ARTIKELNR./
ARTICLE NO.
EB15788

MÅRKSTRØM/
CURRENT RATING
630 A

SPÅNNING/
VOLTAGE
230 V

MEASURING EQUIPMENT	
CURR- TRAFO- SPACE	ENERGY- METER- SPACE

FAST ANSLUTNING/ FIXED CONNECTIONS	
<125A	>125A
2	

CEE-OUTLETS 3-POLE			
16A	32A	63A	125A

SCHUKO OUTLETS	
16A	
6	

CEE-OUTLETS 4-POLE			
16A	32A	63A	125A
1	3	3	1

CEE-OUTLETS 5-POLE/400V			
16A	32A	63A	125A

JFB/RCD/RCBO		
0,01A	0,03A	0,1A
7		3

JFB/RCD/RCBO		
0,3A	0,5A	Variable
		2

VIKT/WEIGHT
kg

This drawing is property of El-Björn. May not be copied, shown or distributed without our written permission.

ZFSF 630NBC 230/02/61331-7032 EN



RITAD A/DRAWN BY CG	DATUM/DATE 220420	NEXT SHEET 2	SHEET 1
SIGN	REVISION/ISSUE A*	RITINGS NR./DRAWING EB15788	

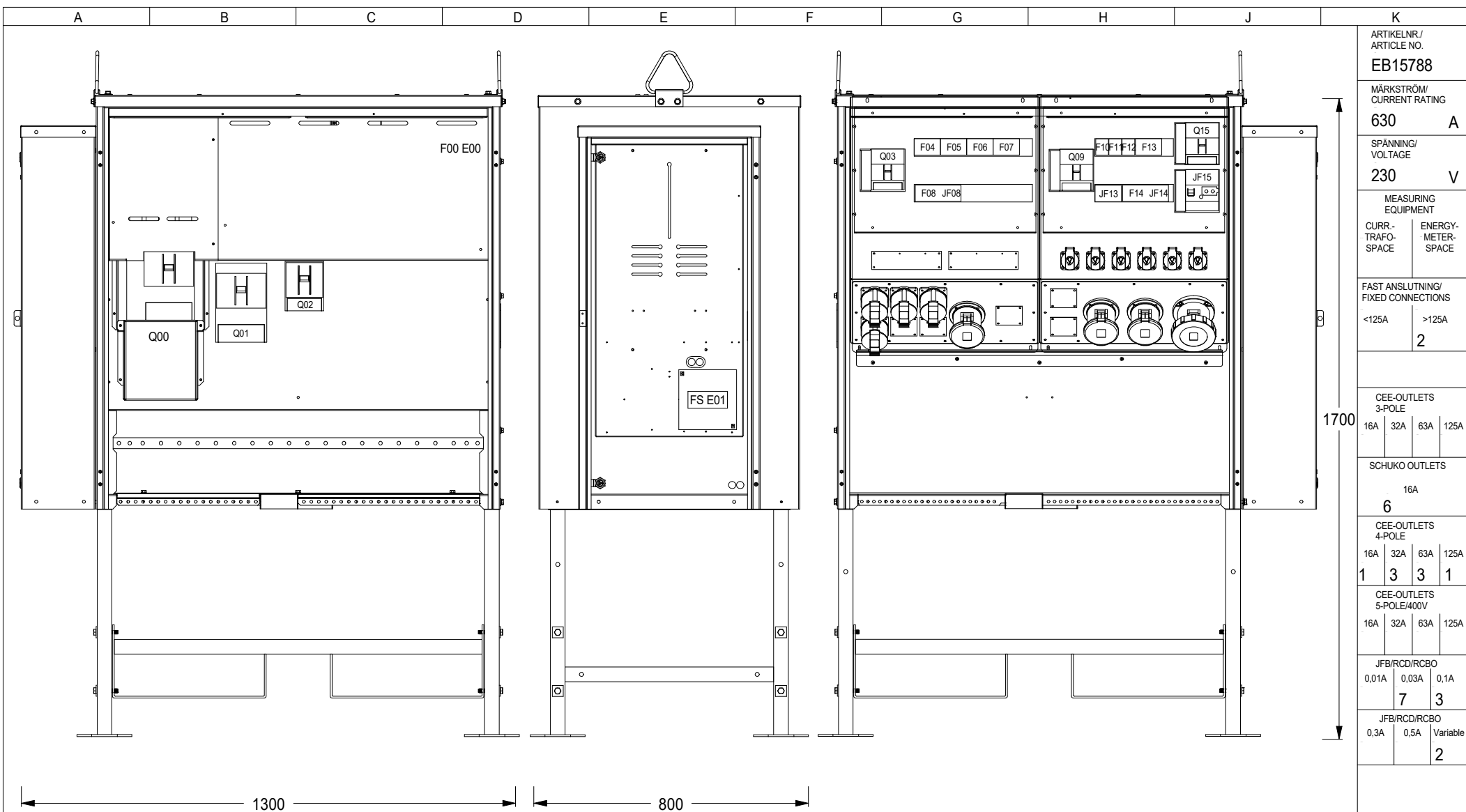

ARTIKELNR/ ARTICLE NO. EB15788			
MÄRKSTRÖM/ CURRENT RATING 630	A		
SPÄNNING/ VOLTAGE 230	V		
MEASURING EQUIPMENT			
CURR- TRAFO- SPACE	ENERGY- METER- SPACE		
FAST ANSLUTNING/ FIXED CONNECTIONS			
<125A	>125A		
2			
CEE-OUTLETS 3-POLE			
16A	32A	63A	125A
SCHUKO OUTLETS			
16A			
6			
CEE-OUTLETS 4-POLE			
16A	32A	63A	125A
1	3	3	1
CEE-OUTLETS 5-POLE/400V			
16A	32A	63A	125A
7			
JFB/RCD/RCBO 0,01A 0,03A 0,1A			
3			
JFB/RCD/RCBO 0,3A 0,5A Variable			
2			
VIKT/WEIGHT			
kg			

This drawing is property of El-Björn. May not be copied, shown or distributed without our written permission.

ZFSF 630NBC 230/02/61331-7032 EN



RITAD A/DRAWN BY CG	DATUM/DATE 220420	NEXT SHEET 3	SHEET 2
SIGN	REVISION/ISSUE A*	RITNING NR./DRAWING EB15788	

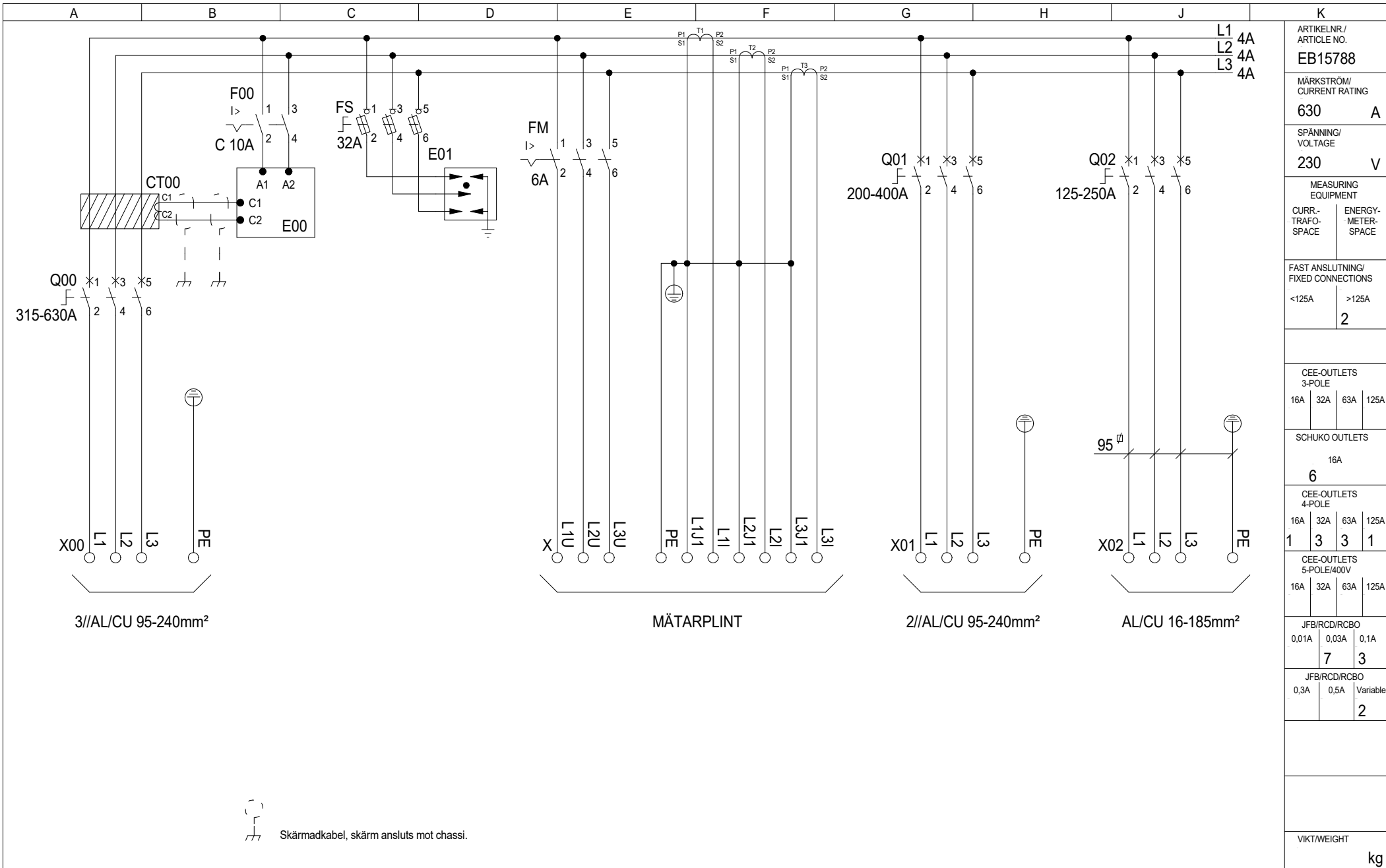

ARTIKELNR./ARTICLE NO. EB15788			
MÄRKSTROM/ CURRENT RATING	630 A		
SPÄNNING/ VOLTAGE	230 V		
MEASURING EQUIPMENT			
CURR.- TRAFI- SPACE	ENERGY- METER- SPACE		
FAST ANSLUTNING/ FIXED CONNECTIONS			
<125A	>125A		
2			
CEE-OUTLETS 3-POLE			
16A	32A	63A	125A
6			
SCHUKO OUTLETS			
16A			
6			
CEE-OUTLETS 4-POLE			
16A	32A	63A	125A
1	3	3	1
CEE-OUTLETS 5-POLE/400V			
16A	32A	63A	125A
7			
JFB/RCD/RCBO			
0,01A	0,03A	0,1A	
7		3	
JFB/RCD/RCBO			
0,3A	0,5A	Variable	
2			
VIKT/WEIGHT			
kg			

This drawing is property of EI-Björn. May not be copied, shown or distributed without our written permission.

ZFSF 630NBC 230/02/61331-7032 EN



RITAD A/DRAWN BY CG	DATUM/DATE 220420	NEXT SHEET 4	SHEET 3
SIGN	REVISION/ISSUE A*	RITNING NR./DRAWING EB15788	

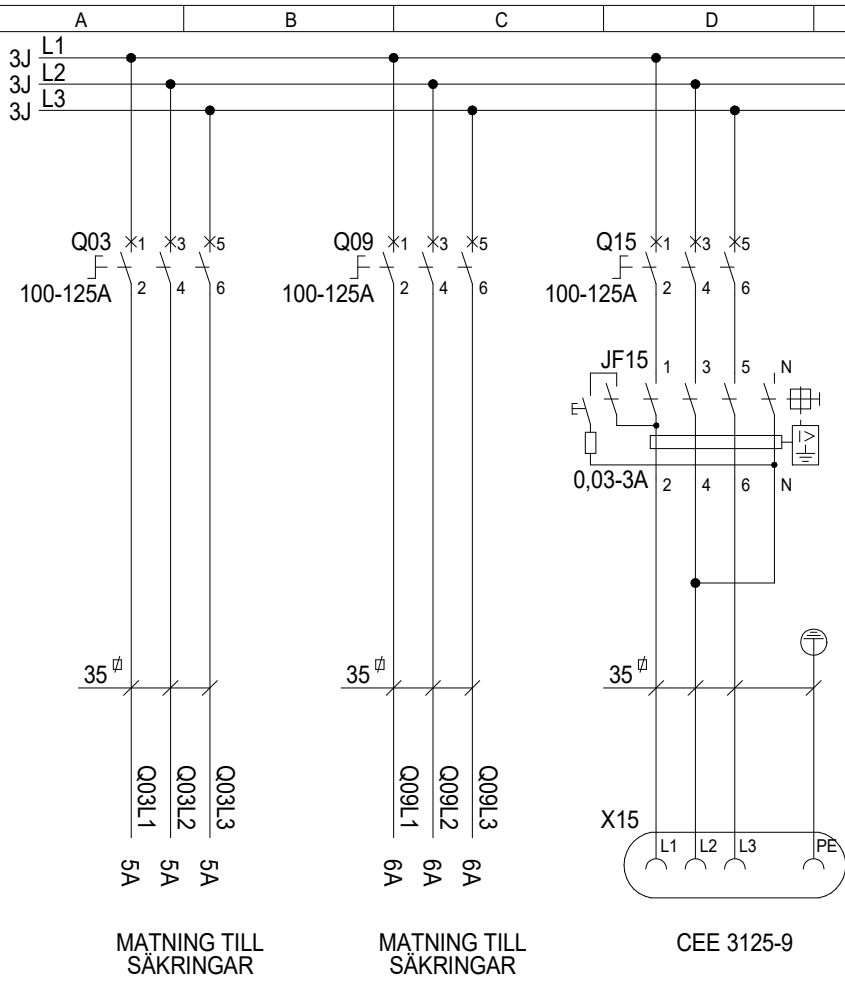

MÄTNING TILL SÄKRINGAR

MÄTNING TILL SÄKRINGAR

CEE 3125-9

L1
L2
L3

ARTIKELNR./
ARTICLE NO.
EB15788

MÄRKSTRÖM/
CURRENT RATING
630 **A**

SPÄNNING/
VOLTAGE
230 **V**

MEASURING
EQUIPMENT
CURR-
TRAFO-
SPACE ENERGY-
METER-
SPACE

FAST ANSLUTNING/
FIXED CONNECTIONS
<125A >125A
2

CEE-OUTLETS
3-POLE
16A 32A 63A 125A

SCHUKO OUTLETS
16A
6

CEE-OUTLETS
4-POLE
16A 32A 63A 125A
1 3 3 1

CEE-OUTLETS
5-POLE/400V
16A 32A 63A 125A

JFB/RCD/RCBO
0,01A 0,03A 0,1A
7 3

JFB/RCD/RCBO
0,3A 0,5A Variable
2

VIKT/WEIGHT
kg

This drawing is property of El-Björn. May not be copied, shown or distributed without our written permission.

ZFSF 630NBC 230/02/61331-7032 EN



RITAD A/DRAWN BY CG	DATUM/DATE 220420	NEXT SHEET 5	SHEET 4
SIGN	REVISION/ISSUE A*	RITNING NR./DRAWING EB15788	

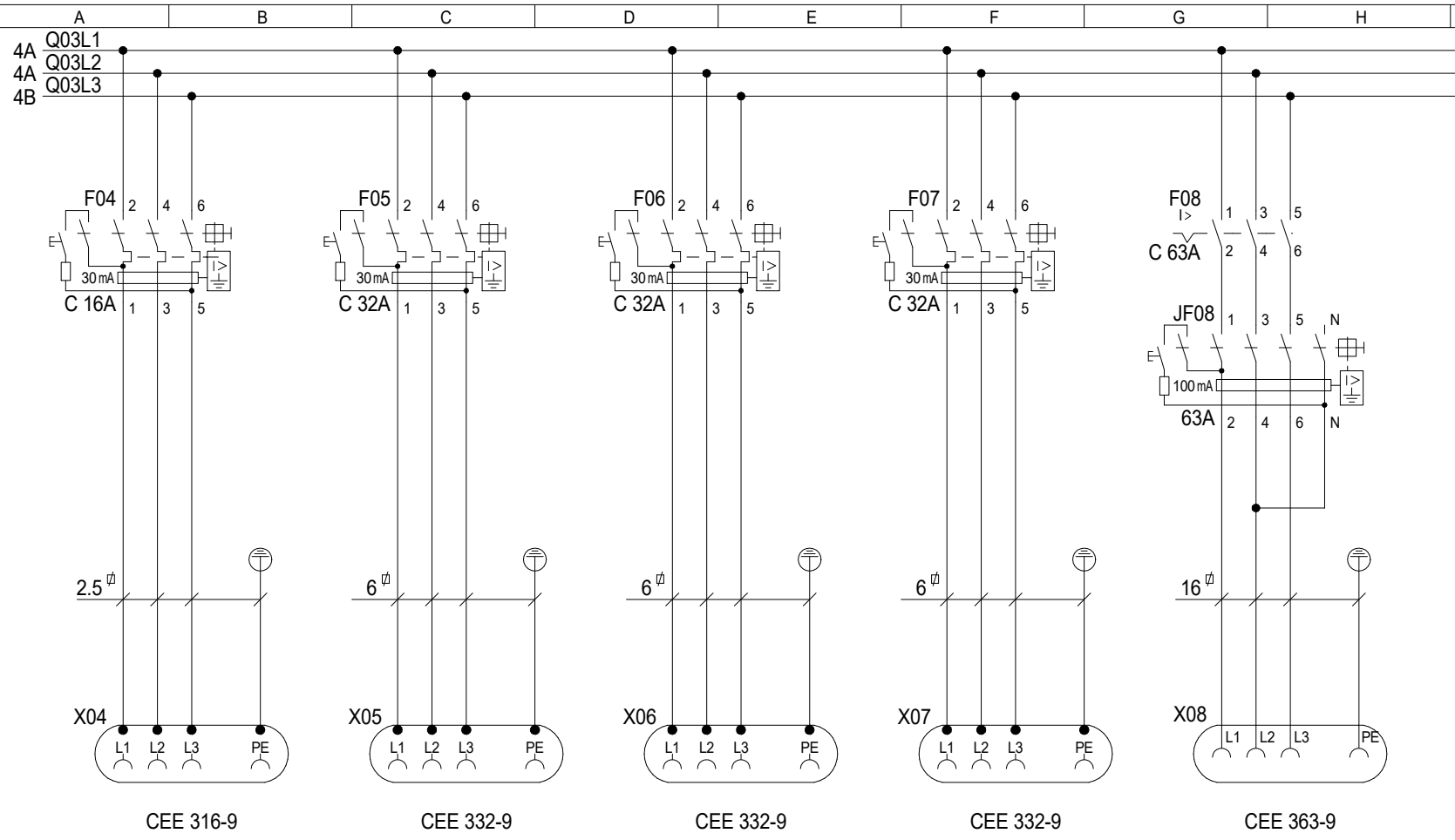

Q03L1
Q03L2
Q03L3

ARTIKELNR./
ARTICLE NO.
EB15788

MÄRKSTROM/
CURRENT RATING
630 A

SPÄNNING/
VOLTAGE
230 V

MEASURING EQUIPMENT	
CURR.-TRAFO-SPACE	ENERGY-METER-SPACE

FAST ANSLUTNING/ FIXED CONNECTIONS	
<125A	>125A
2	

CEE-OUTLETS 3-POLE			
16A	32A	63A	125A

SCHUKO OUTLETS	
16A	
6	

CEE-OUTLETS 4-POLE			
16A	32A	63A	125A
1	3	3	1

CEE-OUTLETS 5-POLE/400V			
16A	32A	63A	125A

JFB/RCD/RCBO		
0,01A	0,03A	0,1A
7		3

JFB/RCD/RCBO		
0,3A	0,5A	Variable
2		

VIKT/WEIGHT	
kg	

This drawing is property of EI-Björn. May not be copied, shown or distributed without our written permission.

ZFSF 630NBC 230/02/61331-7032 EN



RITAD A/DRAWN BY CG	DATUM/DATE 220420	NEXT SHEET 6	SHEET 5
SIGN	REVISION/ISSUE A*	RITNING NR./DRAWING EB15788	

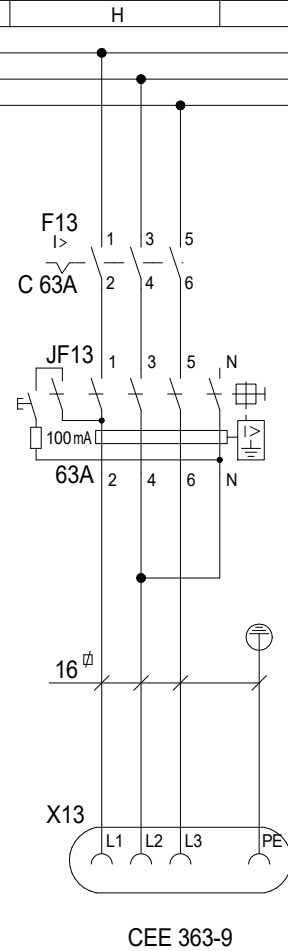
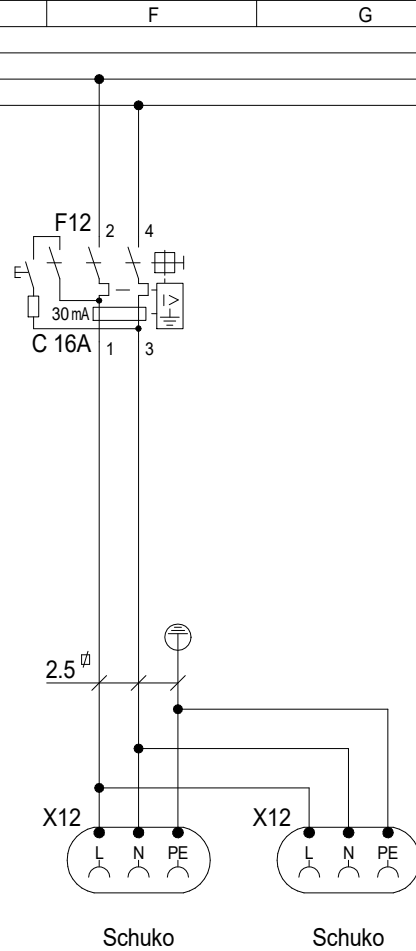
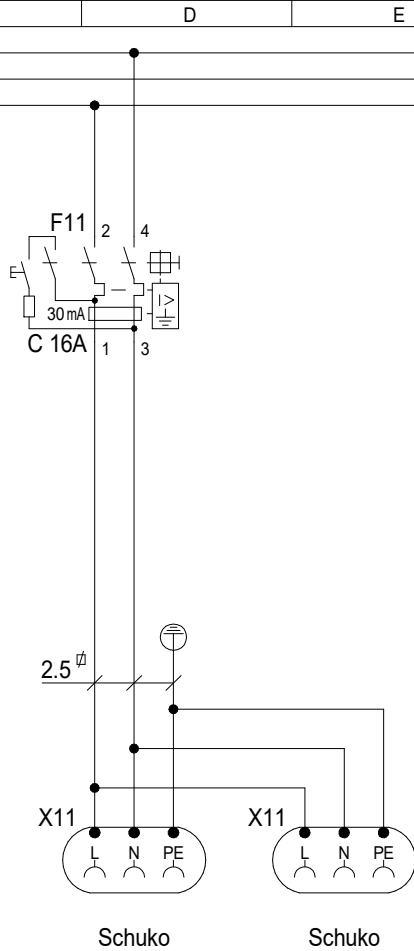
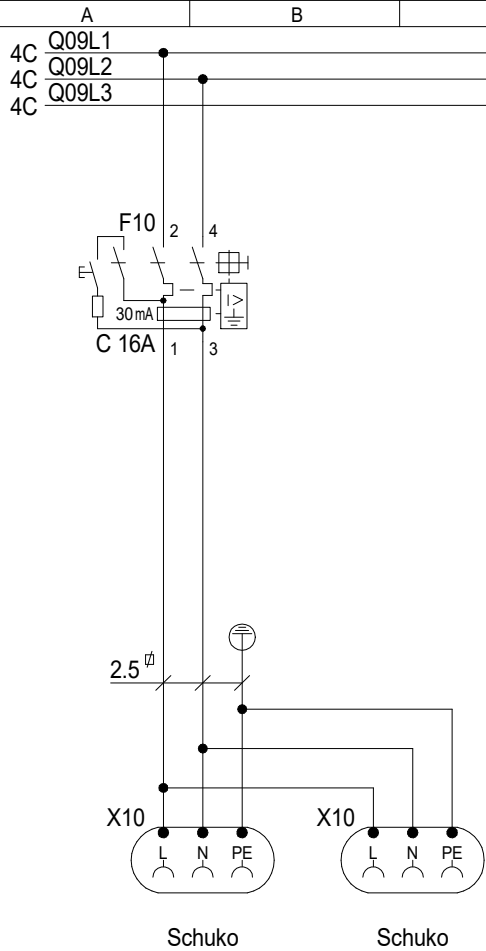

Q09L1 7A
Q09L2 7A
Q09L3 7A

ARTIKELNR./
ARTICLE NO.
EB15788

MÄRKSTRÖM/
CURRENT RATING
630 A

SPÄNNING/
VOLTAGE
230 V

MEASURING
EQUIPMENT
CURR.-
TRAFI-
SPACE ENERGY-
METER-
SPACE

FAST ANSLUTNING/
FIXED CONNECTIONS
<125A >125A
2

CEE-OUTLETS
3-POLE
16A 32A 63A 125A

SCHUKO OUTLETS
16A
6

CEE-OUTLETS
4-POLE
16A 32A 63A 125A
1 3 3 1

CEE-OUTLETS
5-POLE/400V
16A 32A 63A 125A

JFB/RCD/RCBO
0,01A 0,03A 0,1A
7 3

JFB/RCD/RCBO
0,3A 0,5A Variable
2

VIKT/WEIGHT
kg

RITAD A/DRAWN BY CG DATUM/DATE 220420 NEXT SHEET 7 SHEET 6

SIGN REVISION/ISSUE A* RITINGS NR./DRAWING EB15788

This drawing is property of El-Björn. May not be copied, shown or distributed without our written permission.

ZFSF 630NBC 230/02/61331-7032 EN



RITAD A/DRAWN BY CG DATUM/DATE 220420
SIGN REVISION/ISSUE A*

NEXT SHEET 7 SHEET 6
RITINGS NR./DRAWING EB15788

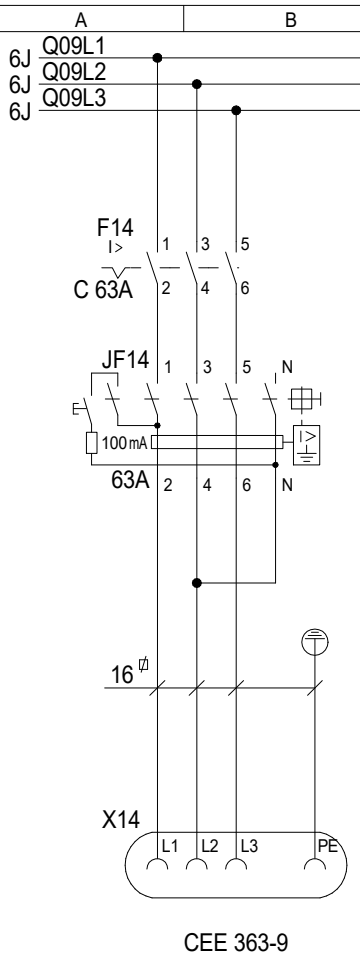

CEE 363-9

A	B	C	D	E	F	G	H	J	K
6J	Q09L1							Q09L1	ARTIKELNR/ ARTICLE NO.
6J	Q09L2							Q09L2	EB15788
6J	Q09L3							Q09L3	MÄRKSTRÖM/ CURRENT RATING
									630 A
									SPÄNNING/ VOLTAGE
									230 V
									MEASURING EQUIPMENT
									CURR- TRAFO- SPACE
									ENERGY- METER- SPACE
									FAST ANSLUTNING/ FIXED CONNECTIONS
									<125A
									>125A
									2
									CEE-OUTLETS 3-POLE
									16A
									32A
									63A
									125A
									SCHUKO OUTLETS
									16A
									6
									CEE-OUTLETS 4-POLE
									16A
									32A
									63A
									125A
									1
									3
									3
									1
									CEE-OUTLETS 5-POLE/400V
									16A
									32A
									63A
									125A
									JFB/RCD/RCBO
									0,01A
									0,03A
									0,1A
									7
									3
									JFB/RCD/RCBO
									0,3A
									0,5A
									Variable
									2
									VIKT/WEIGHT
									kg

This drawing is property of El-Björn. May not be copied, shown or distributed without our written permission.

ZFSF 630NBC 230/02/61331-7032 EN



RITAD A/DRAWN BY	DATUM/DATE	NEXT SHEET	SHEET
CG	220420	8	7
SIGN	REVISION/ISSUE	RITNING NR./DRAWING	
	A*	EB15788	

A	B	C	D	E	F	G	H	J	K
PC.	Position	Description	Type	Manufacturer	Data	Article No.	E-number(SE)		ARTIKELNR/ ARTICLE NO. EB15788
1	.	Skåp	NBC 1100M	El-Björn AB	1300x1700x800mm	K287008			MÄRKSTROM/ CURRENT RATING 630 A
1		Mätarskåp	NBC 230V	El-Björn AB		K287022			SPÄNNING/ VOLTAGE 230 V
1		Insats	6333	El-Björn AB	MCCB + 36mod	K287003			MEASURING EQUIPMENT
2		Täckplåt	3 Schuko	El-Björn AB	50x190, Vit	233116			CURR- TRAFO- SPACE
5		Täckplåt	VE	El-Björn AB	72x72, Vit	75091			ENERGY- METER- SPACE
1		Insats	61121	El-Björn AB	MCCB + 24mod + MCCB	K287007			FAST ANSLUTNING/ FIXED CONNECTIONS <125A >125A 2
1	CT00	Summaströmstrafo	CTG120	Carlo Gavazzi	120mm	CTG120	4262831		CEE-OUTLETS 3-POLE 16A 32A 63A 125A
1	E00	Jordfelsrelä	DEB71DM24A5	Carlo Gavazzi	0,03 - 5A	DEB71DM24A5	3860963		SCHUKO OUTLETS 16A 6
1	E01	Överspänningsskydd	SPCT2-385/3	Eaton	20kA, 3P, 385V	167605			CEE-OUTLETS 4-POLE 16A 32A 63A 125A 1 3 3 1
1	F00	MCB	PLSM-C10/2	Eaton	C 10A, 10kA	242401	2141607		CEE-OUTLETS 5-POLE/400V 16A 32A 63A 125A
1	F04	RCBO	PKPM3-16/3/C/003-A	Eaton	C 16A, 30mA, 10kA	108328			JFB/RCD/RCBO 0,01A 0,03A 0,1A 7 3
3	F05-F07	RCBO	PKPM3-32/3/C/003-A	Eaton	C 32A, 30mA, 10kA	136564			JFB/RCD/RCBO 0,3A 0,5A Variable 2
3	F08, F13-F14	MCB	PLSM-C63/3	Eaton	C 63A, 10kA	242480	2141635		
3	F10-F12	RCBO	PKPM2-16/2/C/003-A	Eaton	C 16A, 30mA, 10kA	108111	2162432		
1	FS	Säkringshållare	DF103	Schneider Electric	3P, 32A, 10x38mm	DF103			
3		Neozedsäkring	C10G32	Eaton	32A, 10x38mm	C10G32			
3	JF08, JF13-JF14	RCD	PFIM-63/4/01-A	Eaton	63A, 100mA, A	235444	2162247		
1	JF15	RCD	NZM1-XFIR	Eaton	0,03-3A, 3P	104605			
1	Q00	MCCB	NZMN3-AE630	Eaton	315-630A, 50kA	259115			
2	Q00-Q01	B-Skydd	NZM3-XKSA	Eaton		260045			
2		Etikett	Moment	El-Björn AB	NZM3	83898			
1	Q01	MCCB	NZMN3-AE400	Eaton	200-400A, 50kA	259114			
1		Anslutning	NZM3-XKA2	Eaton	2//AL/CU 95-240mm²	271461			
1	Q02	MCCB	NZMN2-VE250	Eaton	125-250A, 50kA	259124			
1		B-Skydd	NZM2-XKSA	Eaton		260038			
1		Etikett	Moment	El-Björn AB	NZM2	83897			
3	Q03, Q09, Q15	MCCB	NZMB1-A125	Eaton	100-125A, 25kA	259080			
9	X00	Kabelklämma	AKEB 95-240	Maxeta	95-240mm	8349998			
1	X04	Uttag	316-9	Mennekes	16A, 230V, IP44	1389			
3	X05-X07	Uttag	332-9	Mennekes	32A, 230V, IP44	1398			

VIKT/WEIGHT
kg

This drawing is property of El-Björn. May not be copied, shown or distributed without our written permission.

ZFSF 630NBC 230/02/61331-7032 EN



RITAD A/DRAWN BY
CG
SIGN

DATUM/DATE
220420

REVISION/ISSUE
A*

NEXT SHEET
9

SHEET
8

RITINGS NR./DRAWING
EB15788

