

A	B	C	D	E	F	G	H	J	K
---	---	---	---	---	---	---	---	---	---

INSTRUKSJONER TIL BRUKERE AV MIDLERTIDIGE ELEKTRISKE ANLEGG

1. En kompetent person skal ha tilsyn med anlegget og være ansvarlig for driften. Feil bruk av det elektriske anlegget kan medføre fare for personskade og brann.
2. Sentralen skal plasseres loddrett eller på stativ, og med fritt betjeningsområde foran sentralen.
3. Faste tilkoblinger av kabler og bytte av sikringer skal bare utføres av fagfolk. Ved fast tilkobling av gummikabler skal strekkavlastningens klemflate være utført i isolasjonsmateriale. Ikke-fagfolk skal kun betjene jordfeilbryter, automatsikring og uttak for stikkontakter.
4. Sentralens dører skal være lukket og om nødvendig også låst. Dørene skal bare åpnes ved betjening av sentralen.
5. Elektriske apparater som er koblet til sentralen, skal kobles fra eller gjøres spenningsløse når de ikke er i bruk, for å unngå utilsiktet igangsetting eller anvendelse av disse.
6. De elektriske apparatene som brukes, må oppfylle forskriftene og skal enten være utstyrt med ekstra isolasjon eller, i klasse 1-utførelse, med jordet stikkontakt.
7. Kabler må legges slik at de ikke blir skadet. Det gjelder kabler både innenfor og utenfor dørene.
8. Kabler eller apparater med feil skal frakobles og ikke tas i bruk igjen før de defekte delene er skiftet eller reparert.
9. Knivsikring må bare byttes av kompetent personale.

INSTRUCTIONS FOR USERS OF TEMPORARY ELECTRICAL INSTALLATIONS

1. Operation of the installation must be supervised by an authorised person. Incorrect use of the electrical installation could mean risk of personal injury and fire.
2. The distribution unit must be installed vertical or on a stand so that there is free access in front of the unit.
3. Permanent cable connection or replacement of fuses may only be carried out by qualified personnel. Permanently connected rubber-insulated cables must be secured with a restraint that has an insulating gripping surface. Unqualified personnel may only operate earth leakage circuit breakers, miniature circuit breakers and plug sockets.
4. Distribution unit doors must be closed and, where required, also locked. Doors must only be left open when carrying out work on the distribution unit.
5. Electrical equipment that is connected to distribution units must be disconnected or switched off when not in use in order to avoid unintentional starting up or switching on.
6. Electrical equipment that is used must comply with the requirements and must either have additional insulation or comply with class I and have an earthed plug.
7. Cables inside and outside the doors must be routed so as to avoid damaging them.
8. Cables or equipment that are defective must be disconnected and not used until the defective parts have been replaced or repaired.
9. Blade fuses may only be replaced by personnel who have the necessary training.

ARTIKELNR./
ARTICLE NO.
EB15778

MÅRKSTRØM/
CURRENT RATING
630 A

SPÅNNING/
VOLTAGE
400 V

MEASURING EQUIPMENT	
CURR- TRAFO- SPACE	ENERGY- METER- SPACE
1	1

FAST ANSLUTNING/ FIXED CONNECTIONS	
<125A	>125A
	2

CEE-OUTLETS 3-POLE			
16A	32A	63A	125A

SCHUKO OUTLETS	
16A	
6	

CEE-OUTLETS 4-POLE			
16A	32A	63A	125A

CEE-OUTLETS 5-POLE/400V			
16A	32A	63A	125A
1	3	3	1

JFB/RCD/RCBO		
0,01A	0,03A	0,1A
7		

JFB/RCD/RCBO		
0,3A	0,5A	Variable
3		1

VIKT/WEIGHT
140 kg

RITAD AV/DRAWN BY CG	DATUM/DATE 220405	NEXT SHEET 2	SHEET 1
SIGN	REVISION/ISSUE A*	RITINGS NR./DRAWING EB15778	

ZFSF 630NBC/02/61331-7031 EN 4P



This drawing is property of El-Björn. May not be copied, shown or distributed without our written permission.

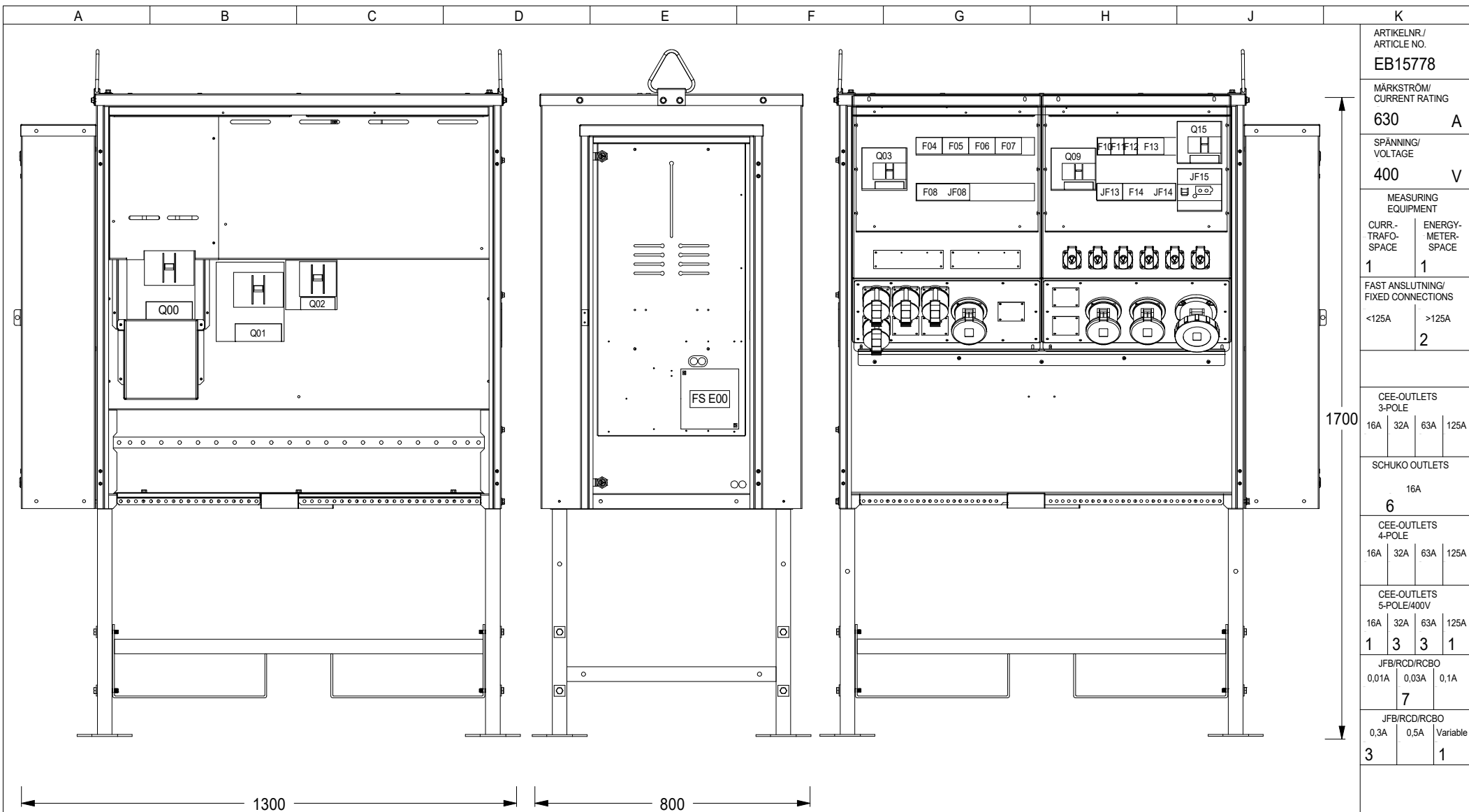

ARTIKELNR./ ARTICLE NO. EB15778			
MÄRKSTRÖM/ CURRENT RATING 630	A		
SPÄNNING/ VOLTAGE 400	V		
MEASURING EQUIPMENT			
CURR- TRAFO- SPACE 1	ENERGY- METER- SPACE 1		
FAST ANSLUTNING/ FIXED CONNECTIONS			
<125A	>125A		
	2		
CEE-OUTLETS 3-POLE			
16A	32A	63A	125A
SCHUKO OUTLETS			
16A			
6			
CEE-OUTLETS 4-POLE			
16A	32A	63A	125A
CEE-OUTLETS 5-POLE/400V			
16A	32A	63A	125A
1	3	3	1
JFB/RCD/RCBO			
0,01A	0,03A	0,1A	
7			
JFB/RCD/RCBO			
0,3A	0,5A	Variable	
3	1		

This drawing is property of El-Björn. May not be copied, shown or distributed without our written permission.

ZFSF 630NBC/02/61331-7031 EN 4P



RITAD A/DRAWN BY CG	DATUM/DATE 220405	NEXT SHEET 3	SHEET 2
SIGN	REVISION/ISSUE A*	RITINGS NR./DRAWING EB15778	

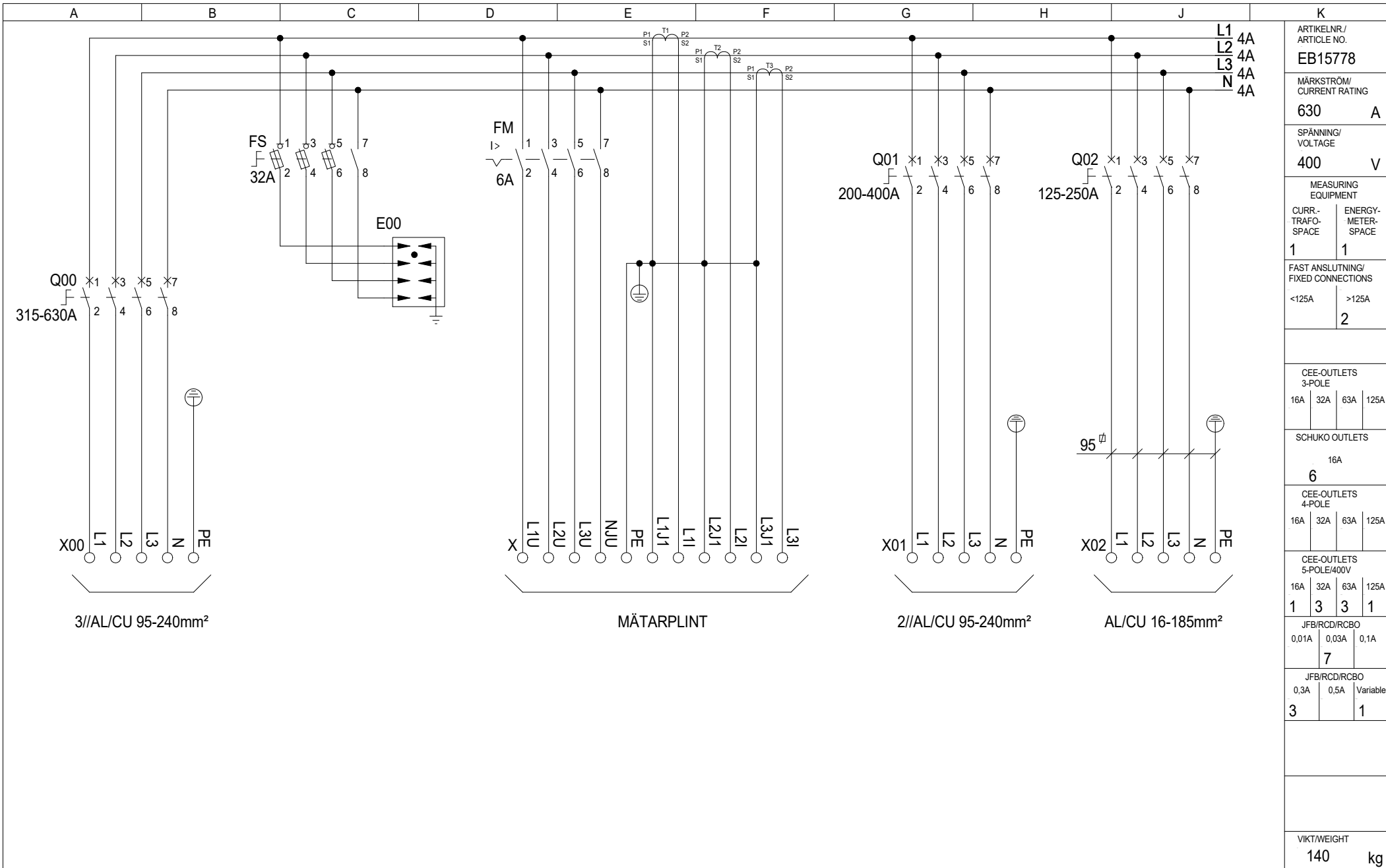

ARTIKELNR./ ARTICLE NO. EB15778			
MÄRKSTROM/ CURRENT RATING 630	A		
SPÄNNING/ VOLTAGE 400	V		
MEASURING EQUIPMENT			
CURR- TRAFO- SPACE 1	ENERGY- METER- SPACE 1		
FAST ANSLUTNING/ FIXED CONNECTIONS			
<125A	>125A		
	2		
CEE-OUTLETS 3-POLE			
16A	32A	63A	125A
SCHUKO OUTLETS			
16A			
6			
CEE-OUTLETS 4-POLE			
16A	32A	63A	125A
1	3	3	1
CEE-OUTLETS 5-POLE/400V			
0,01A	0,03A	0,1A	
7			
JFB/RCD/RCBO			
0,3A	0,5A	Variable	
3	1		
VIKT/WEIGHT			
140	kg		

This drawing is property of EI-Björn. May not be copied, shown or distributed without our written permission.

ZFSF 630NBC/02/61331-7031 EN 4P



RITAD A/DRAWN BY CG	DATUM/DATE 220405	NEXT SHEET 4	SHEET 3
SIGN	REVISION/ISSUE A*	RITINGS NR./DRAWING EB15778	

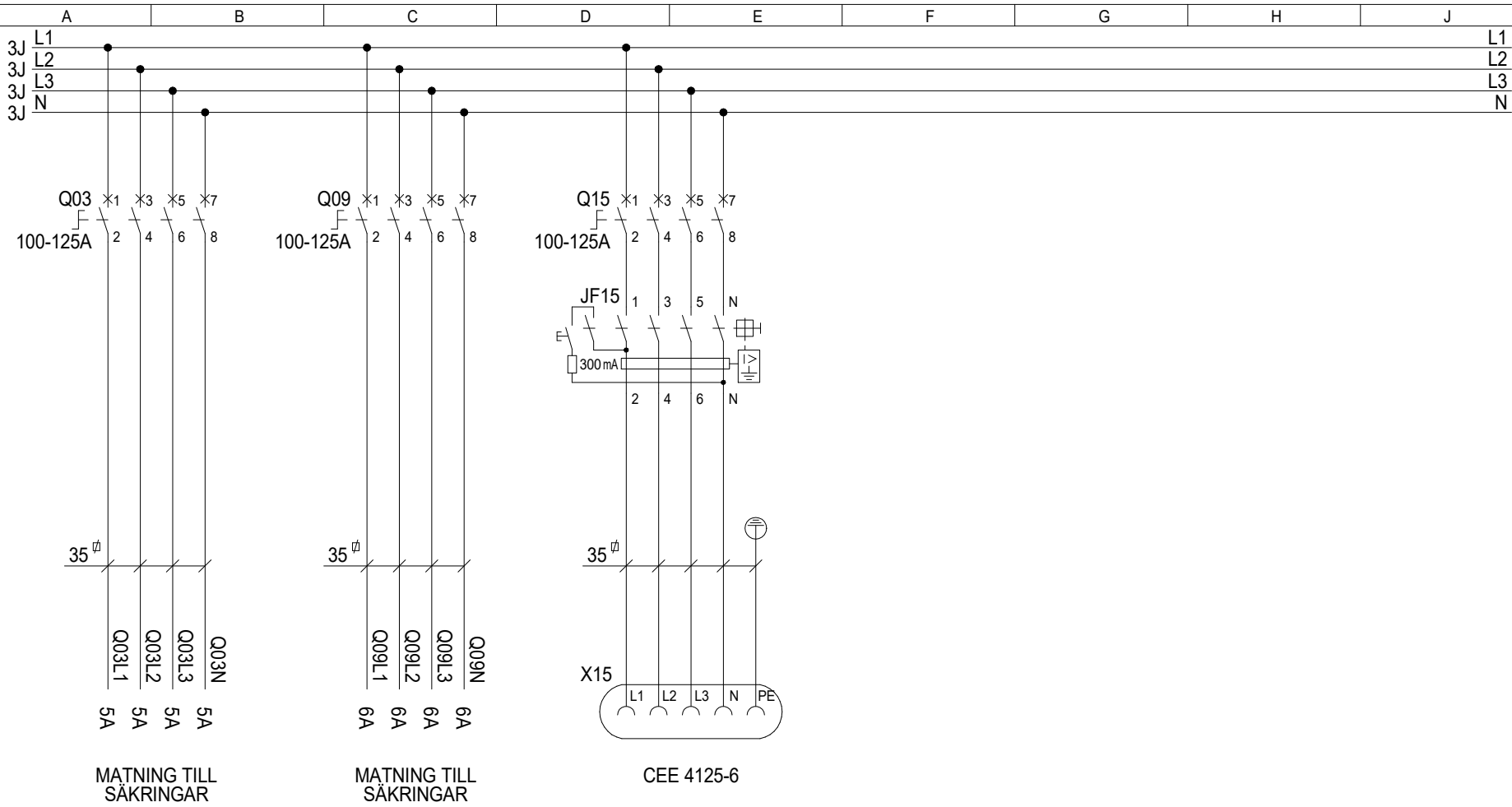

ARTIKELNR/ ARTICLE NO.		EB15778	
MÄRKSTRÖM/ CURRENT RATING		630	A
SPÄNNING/ VOLTAGE		400	V
MEASURING EQUIPMENT			
CURR- TRAFI- SPACE	ENERGY- METER- SPACE	1	1
FAST ANSLUTNING/ FIXED CONNECTIONS			
<125A	>125A	2	
CEE-OUTLETS 3-POLE			
16A	32A	63A	125A
SCHUKO OUTLETS			
16A			
6			
CEE-OUTLETS 4-POLE			
16A	32A	63A	125A
1	3	3	1
CEE-OUTLETS 5-POLE/400V			
16A	32A	63A	125A
1	3	3	1
JFB/RCD/RCBO			
0,01A	0,03A	0,1A	
7			
JFB/RCD/RCBO			
0,3A	0,5A	Variable	
3	1		
VIKT/WEIGHT			
140		kg	

This drawing is property of El-Björn. May not be copied, shown or distributed without our written permission.

ZFSF 630NBC/02/61331-7031 EN 4P



RITAD A/DRAWN BY	DATUM/DATE	NEXT SHEET	SHEET
CG	220405	5	4
SIGN	REVISION/ISSUE	RITNING NR./DRAWING	
	A*	EB15778	

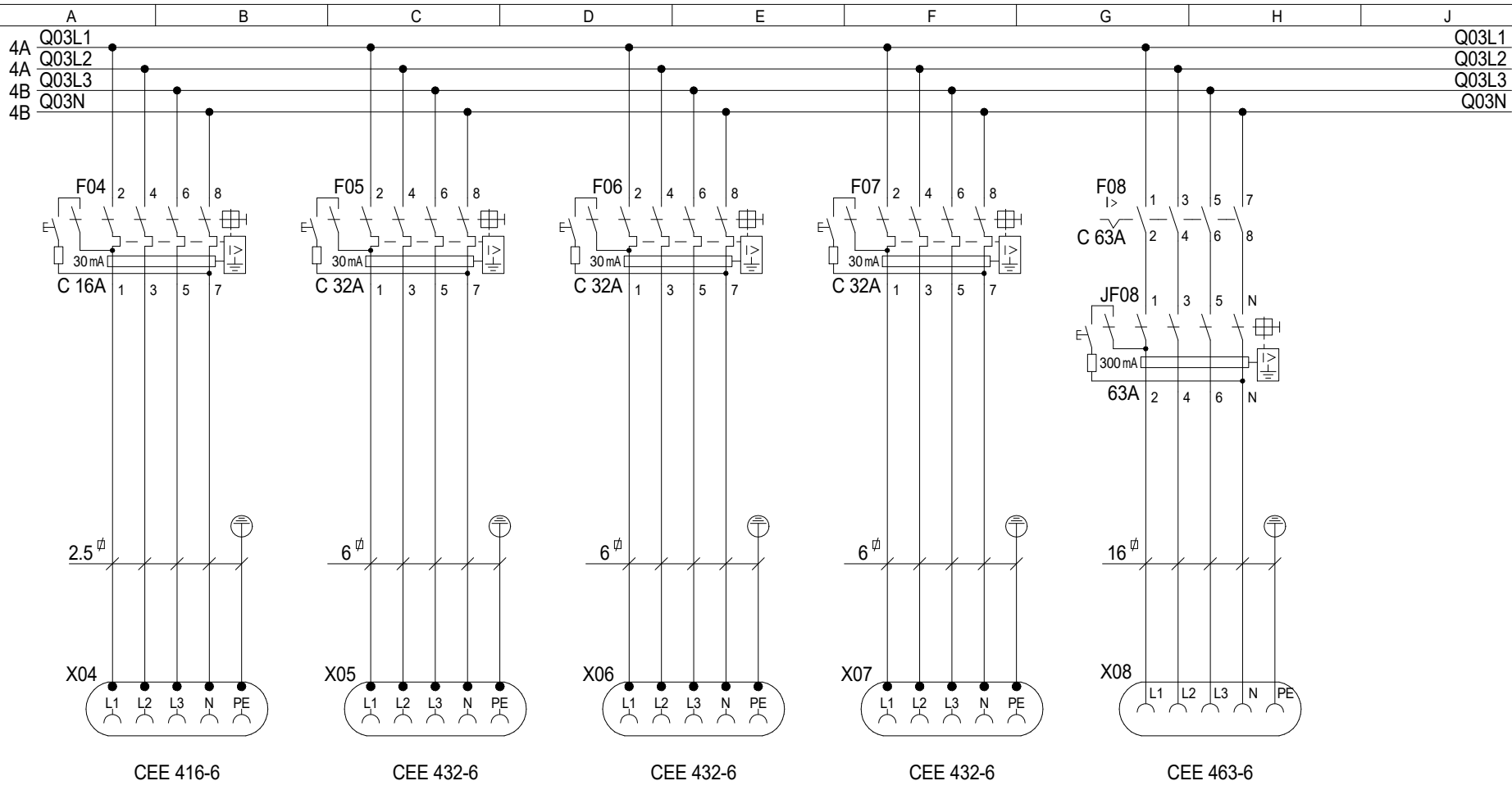

Q03L1
Q03L2
Q03L3
Q03N

ARTIKELNR./
ARTICLE NO.
EB15778

MÄRKSTROM/
CURRENT RATING
630 A

SPÄNNING/
VOLTAGE
400 V

MEASURING EQUIPMENT	
CURR.- TRAFOS- SPACE	ENERGY- METER- SPACE
1	1

FAST ANSLUTNING/ FIXED CONNECTIONS	
<125A	>125A
	2

CEE-OUTLETS 3-POLE			
16A	32A	63A	125A

SCHUKO OUTLETS	
16A	6

CEE-OUTLETS 4-POLE			
16A	32A	63A	125A

CEE-OUTLETS 5-POLE/400V			
16A	32A	63A	125A
1	3	3	1

JFB/RCD/RCBO		
0,01A	0,03A	0,1A
7		

JFB/RCD/RCBO		
0,3A	0,5A	Variable
3		1

VIKT/WEIGHT
140 kg

This drawing is property of EI-Björn. May not be copied, shown or distributed without our written permission.

ZFSF 630NBC/02/61331-7031 EN 4P



RITAD A/DRAWN BY CG	DATUM/DATE 220405	NEXT SHEET 6	SHEET 5
SIGN	REVISION/ISSUE A*	RITINGS NR./DRAWING EB15778	

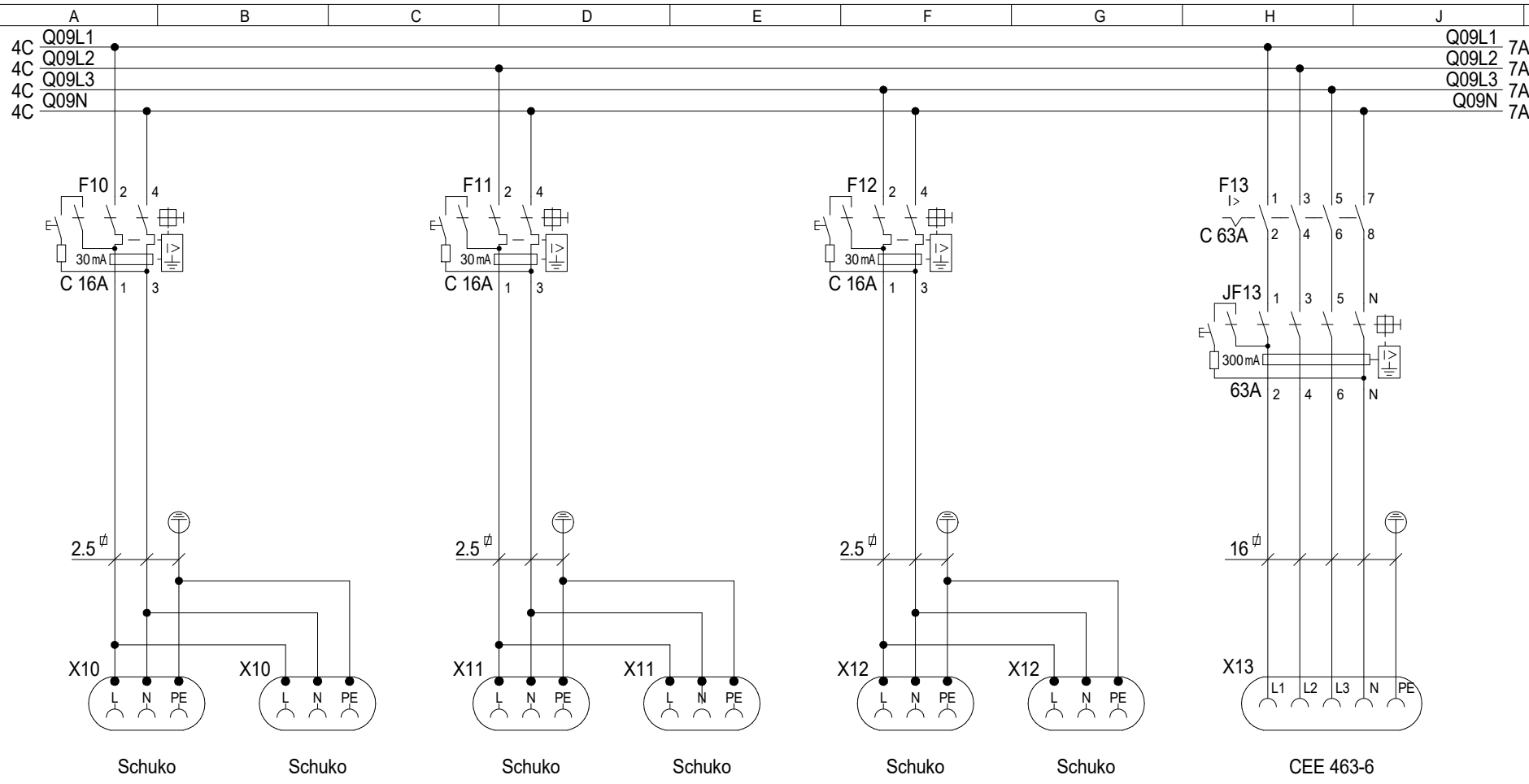

Q09L1 7A
 Q09L2 7A
 Q09L3 7A
 Q09N 7A

ARTIKELNR./
 ARTICLE NO.
EB15778

MÄRKSTROM/
 CURRENT RATING
630 A

SPÄNNING/
 VOLTAGE
400 V

MEASURING EQUIPMENT	
CURR-TRAFO-SPACE	ENERGY-METER-SPACE
1	1

FAST ANSLUTNING/ FIXED CONNECTIONS	
<125A	>125A
	2

CEE-OUTLETS 3-POLE			
16A	32A	63A	125A

SCHUKO OUTLETS	
16A	
6	

CEE-OUTLETS 4-POLE			
16A	32A	63A	125A

CEE-OUTLETS 5-POLE/400V			
16A	32A	63A	125A
1	3	3	1

JFB/RCD/RCBO		
0,01A	0,03A	0,1A
7		

JFB/RCD/RCBO		
0,3A	0,5A	Variable
3		1

VIKT/WEIGHT	
140	kg

This drawing is property of EI-Björn. May not be copied, shown or distributed without our written permission.

ZFSF 630NBC/02/61331-7031 EN 4P



RITAD A/DRAWN BY CG	DATUM/DATE 220405	NEXT SHEET 7	SHEET 6
SIGN	REVISION/ISSUE A*	RITINGS NR./DRAWING EB15778	

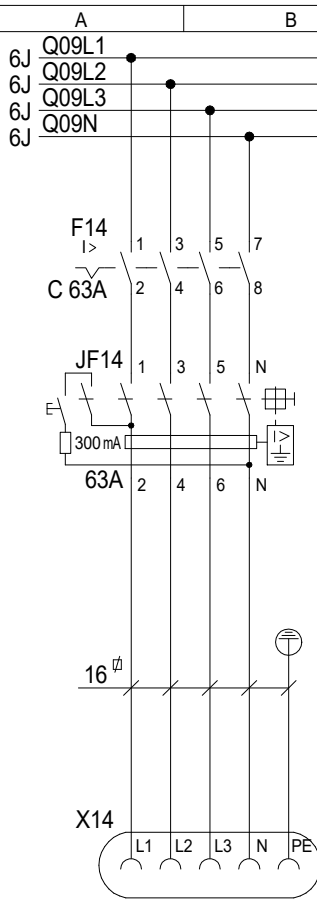

CEE 463-6

6J	Q09L1										Q09L1	ARTIKELNR/ ARTICLE NO. EB15778
6J	Q09L2										Q09L2	
6J	Q09L3										Q09L3	
6J	Q09N										Q09N	

MÄRKSTRÖM/ CURRENT RATING		630	A
SPÄNNING/ VOLTAGE		400	V
MEASURING EQUIPMENT			
CURR- TRAFO- SPACE	ENERGY- METER- SPACE	1	1
FAST ANSLUTNING/ FIXED CONNECTIONS			
<125A		>125A	
		2	
CEE-OUTLETS 3-POLE			
16A	32A	63A	125A
SCHUKO OUTLETS			
16A			
6			
CEE-OUTLETS 4-POLE			
16A	32A	63A	125A
1	3	3	1
CEE-OUTLETS 5-POLE/400V			
16A	32A	63A	125A
1	3	3	1
JFB/RCD/RCBO			
0,01A	0,03A	0,1A	
7			
JFB/RCD/RCBO			
0,3A	0,5A	Variable	
3		1	
VIKT/WEIGHT			
140		kg	

This drawing is property of El-Björn. May not be copied, shown or distributed without our written permission.

ZFSF 630NBC/02/61331-7031 EN 4P



RITAD A/DRAWN BY CG	DATUM/DATE 220405	NEXT SHEET 8	SHEET 7
SIGN	REVISION/ISSUE A*	RITNING NR./DRAWING EB15778	

A	B	C	D	E	F	G	H	J	K
PC.	Position	Description	Type	Manufacturer	Data	Article No.	E-number(SE)		ARTIKELNR/ ARTICLE NO. EB15778
1	.	Skåp	NBC 1100M	El-Björn AB	1300x1700x800mm	K287008			MÄRKSTROM/ CURRENT RATING 630 A
1		Mätarskåp	NBC 400V	El-Björn AB		K287004			SPÄNNING/ VOLTAGE 400 V
1		Insats	6333	El-Björn AB	MCCB + 36mod	K287003			MEASURING EQUIPMENT
2		Täckplåt	3 Schuko	El-Björn AB	50x190, Vit	233116			CURR- TRAFO- SPACE
5		Täckplåt	VE	El-Björn AB	72x72, Vit	75091			ENERGY- METER- SPACE
1		Insats	61121	El-Björn AB	MCCB + 24mod + MCCB	K287007			1 1
1	E00	Överspänningsskydd	SPCT2-385/4	Eaton	20kA, 4P, 385V	167606			FAST ANSLUTNING/ FIXED CONNECTIONS <125A >125A 2
1	F04	RCBO	mRB6-16/3N/C/003-A	Eaton	C 16A, 30mA, 6kA	120660			CEE-OUTLETS 3-POLE 16A 32A 63A 125A
3	F05-F07	RCBO	mRB4-32/3N/C/003-A	Eaton	C 32A, 30mA, 4,5kA	167508			SCHUKO OUTLETS 16A 6
3	F08, F13-F14	MCB	PLSM-C63/3N	Eaton	C 63A, 10kA	242549			CEE-OUTLETS 4-POLE 16A 32A 63A 125A
3	F10-F12	RCBO	PKPM2-16/2/C/003-A	Eaton	C 16A, 30mA, 10kA	108111	2162432		CEE-OUTLETS 5-POLE/400V 16A 32A 63A 125A 1 3 3 1
1	FS	Säkringshållare	DF103N	Schneider Electric	4P, 32A, 10x38mm	DF103N			JFB/RCD/RCBO 0,01A 0,03A 0,1A 7
3		Neozedsäkring	C10G32	Eaton	32A, 10x38mm	C10G32			JFB/RCD/RCBO 0,3A 0,5A Variable 3 1
3	JF08, JF13-JF14	RCD	PFIM-63/4/03-A-MV	Eaton	63A, 300mA, A	235445	2162249		
1	JF15	RCD	NZM1-4-XFIR	Eaton	0,03-3A, 4P	104608			
1	Q00	MCCB	NZMN3-4-AE630	Eaton	315-630A, 50kA	265894			
2	Q00-Q01	B-Skydd	NZM3-4-XKSA	Eaton		266801			
2		Etikett	Moment	El-Björn AB	NZM3	83898			
1	Q01	MCCB	NZMN3-4-AE400	Eaton	200-400A, 50kA	265891			
1		Anslutning	NZM3-4-XKA2	Eaton	2//AL/CU 95-240mm ²	271462			
1	Q02	MCCB	NZMN2-4-VE250	Eaton	125-250A, 50kA	265938			
1		B-Skydd	NZM2-4-XKSA	Eaton		266770			
1		Anslutning	NZM2-4-XKA	Eaton	AL/CU 16-185mm ²	266756			
1		Etikett	Moment	El-Björn AB	NZM2	83897			
3	Q03, Q09, Q15	MCCB	NZMB1-4-A125	Eaton	100-125A, 25kA	265809			
12	X00	Kabelklämma	AKEB 95-240	Maxeta	95-240mm	8349998			
1	X04	Uttag	416-6	Mennekes	16A, 400V, IP44	1385			
3	X05-X07	Uttag	432-6	Mennekes	32A, 400V, IP44	3451			
3	X08, X13-X14	Uttag	463-6	Mennekes	63A, 400V, IP44	1252A			
6	X10-X12	Schukouttag	Typ F	Mennekes	16A, 230V, IP54	11020EB			
1	X15	Uttag	4125-6	Mennekes	125A, 400V, IP67	1461			

VIKT/WEIGHT
140 kg

This drawing is property of El-Björn. May not be copied, shown or distributed without our written permission.

ZFSF 630NBC/02/61331-7031 EN 4P



RITAD A/DRAWN BY CG	DATUM/DATE 220405	NEXT SHEET	SHEET 8
SIGN	REVISION/ISSUE A*	RITNING NR./DRAWING EB15778	